



## Data Sheet High Performance Door **RapidRoll® 420**

Multifunctional utilisation for  
medium sized dimensions

In series equipped with the RollTex® door curtain.

MCC<sup>VectorControl</sup> control system as standard - for fast and soft door movement.

Strong dimensioned tension springs care for the weight balance,  
the curtain tension and an effective wind load stability.

SRD - self repairing knock-out capability as an option.

Model RapidRoll® 420 Frigo H for deep freeze transport and stock areas as an option.



Next generation of High  
Performance Door control systems

INTERIOR ● EXTERIOR  
PROCESS ○ SERVICE

# High Performance Door RapidRoll® 420



## ADVANTAGES OF ALBANY RAPIDROLL® 420

- a curtain tension and counterbalance system; assures of a perfectly secure opening and closing movement and permanent curtain tension in all situations
- extremely robust, tear resistant RollTex fabric with 5 years guarantee (see our special terms of guarantee)

## APPLICATION

- to separate rooms and environments, saving energy
- for deep freeze transport and store area
- as machine protection door (RapidProtect)

## DESIGN

The top roll consists of a steel tube with welded end caps. The shafts are supported on both sides by bearings. The curtain is riveted to the top roll, and sealed towards the wall.

Side frames of aluminium or galvanised steel on both sides of the curtain guide its upward and downward motion. The simple hinge principle assures quick and easy opening for service. A cover made of anodised aluminium on the front side protects the top roll as option.

## DOOR CURTAIN

The door curtain is made of extremely rigid, tear resistant RollTex® fabric: tensile strength 185 kN/m. The coated fabric seals against moisture and drafts. Standard colours are blue, orange and grey.

The counterbalance system is achieved by tension springs. Additionally, the tension spring system assures a firm and taut curtain regardless of wind loads.

## KNOCK-OUT CAPABILITY (SRD)

Available as option.

## DRIVE UNIT

A 3 Phase motor with a worm gear is connected directly to the top roll. Left- or right-hand position available.

## CONTROL SYSTEM

The door comes with the MCC<sup>Vector Control</sup> system which is Albany's new, highly flexible frequency converter control system. As option control system ACS 50 is available. See technical data.

## MANUAL ACTIVATION

In the event of a power failure the door curtain can be manually released and simply lifted supported by the tension springs of the counterbalance system.

## SAFETY FEATURES

The door is designed according to the regulations of the Workplace Directive of the UVV as well as the harmonized CE Guidelines including the EN 13241-1

## INDICATION OF RISK

The security of the door is designed for normal use for vehicles in industrial environment corresponding to the harmonized CE-Guidelines. In consideration of the situation on site – especially in case of use by pedestrians – additional safety measures, like additional actuators may be required. In addition, special environmental conditions may have impact on the right choice of doortype. In case of any doubt please contact our sales engineer for advice in your application.

Technical Data		
<b>Interior door</b>	suitable	
<b>Exterior door</b>	suitable	
<b>Deep freezer application (Frigo H)</b>	•	
<b>Wind resistance</b>	class 1 - EN 12424	
<b>Door dimension (mm)</b>	For details please note general drawing!	
DW min. / max.	1500 / 5500 mm	
DH min. / max.	1500 / 5500 mm	
<b>Opening direction</b>	vertical	
<b>Surface</b>		
Side frames	✓	galvanised steel
Side frames	•	anodised aluminium
Top roll	steel tube	
Bottom profile	anodised aluminium	
<b>Covers (optional)</b>		
Motor and top roll cover	• <sup>1)</sup>	aluminium
<b>Door curtain (alternatively)</b>		
PVC with alternative coloured reinforcement stripes	•	up to 4 x 4,2 m
RollTex® plus	✓	
- without windows	✓	
- with windows	•	
RollTex® Original (acryl-coated)	•	
NomaTex® with vision panel	•	
<b>Anti-Static brush</b>	✓	
<b>Curtain tension</b>	✓	
<b>Counterbalance</b>	✓	
<b>Drive unit</b>	elektrical IP 54	
<b>Chain drive</b>	•	
<b>Control systems</b>		
ACS 50	•	
MCC <sup>VectorControl</sup>	✓	
<b>Safety</b>		
Electrical safety contact edge	✓	
Door line photocell	✓	
Fall down protection	✓	tension springs
Knock-out capability (SRD)	•	
Manual activation	✓	with bowden lever operated from the floor
Second bowden lever	•	
<b>Speed (m/s)</b>	<b>ACS 50</b>	<b>MCC<sup>VectorControl</sup></b>
open/close up to max. m/s (standard)	1,0/1,0	2,5/0,8
open/close up to max. m/s (option)	1,7/0,8	3,0/0,8
Fuse protection	6,3 A	10/16 A
Control voltage	24 V DC	24 V DC
Protection degree	IP 55	IP 65
Motor power / kW	0,55-1,1 kW	1,1 kW
3L(N)/PE/220/230/380/400/415V; 50 Hz	✓ <sup>2)</sup>	
3(N) PE 220 VAC-10%/ 480 VAC + 5%/50/60Hz		✓
Additional opening heights	•	✓
Potential free contacts max. 250 V	✓	•
<b>Traffic light function</b>		
without direction detection	✓	✓24 V DC
with direction detection	—	✓24 V DC
Flashing alarm light	✓	✓24 V DC
Error message	✓LED	✓graphical display
•Option ✓Standard — not available		

<sup>1)</sup> For doors of height ≤ 2500 m the use of top roll and motor cover is required according to standard EN 13241-1.

<sup>2)</sup> Transformer necessary for 440/480/500V

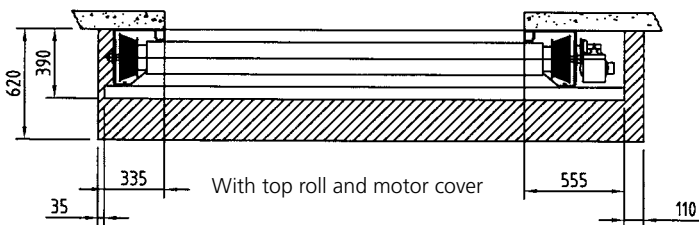
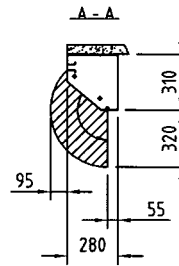
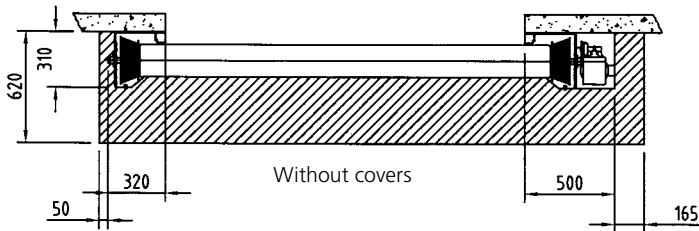
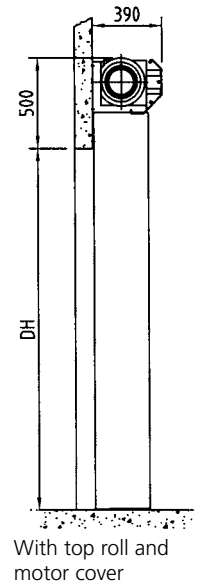
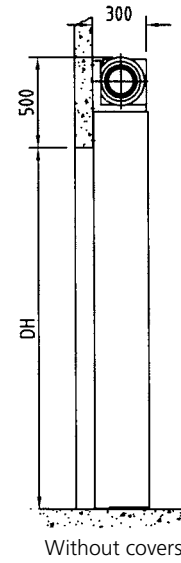
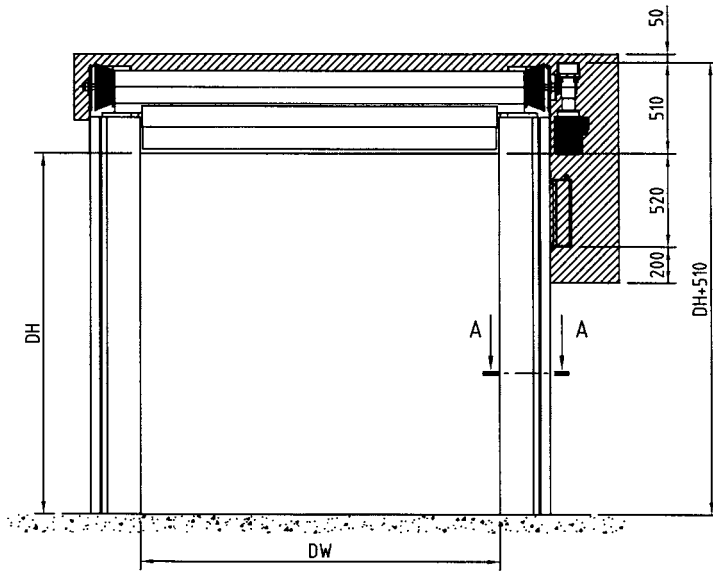

The drive unit shown here is mounted on the right-hand side of the door, but left-hand side units are also available.

Shaded areas indicate the space that is needed for installation and servicing. If the required space is not available, please consult Albany Door Systems.

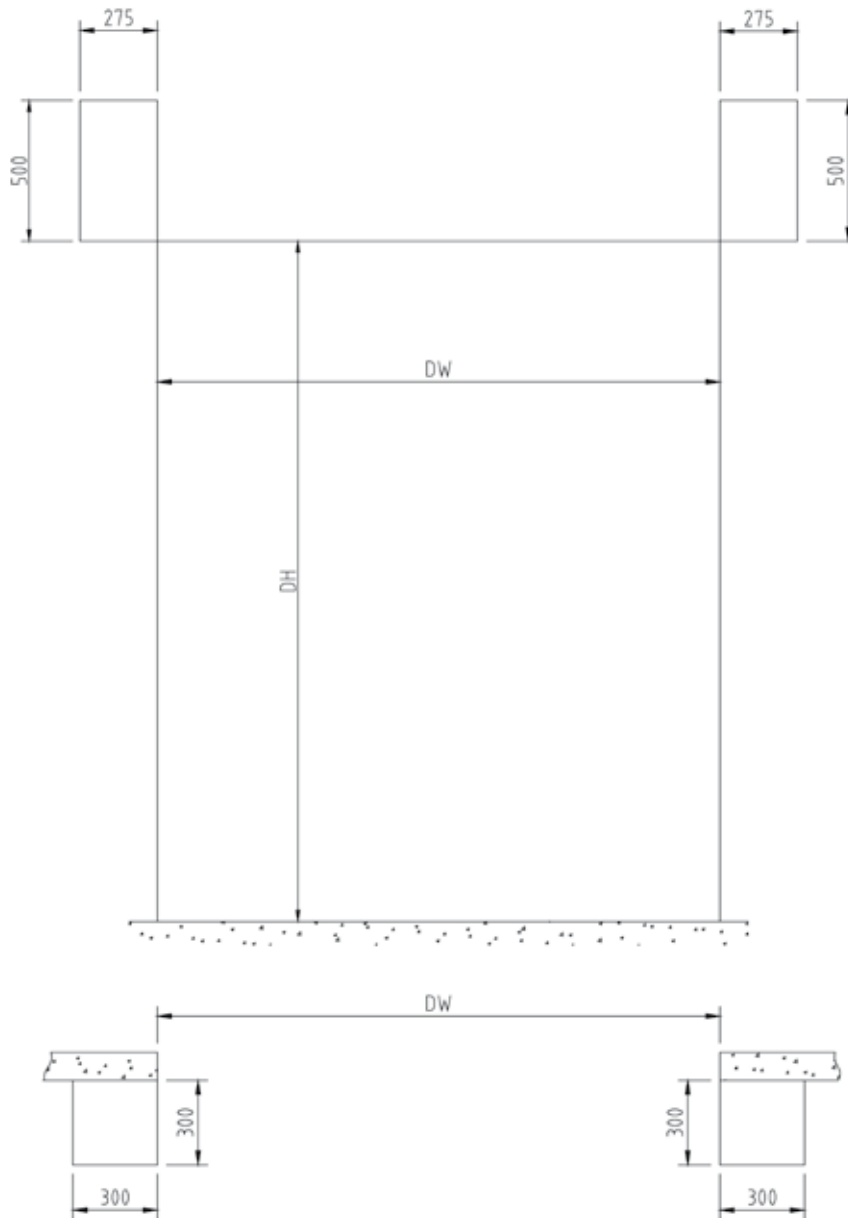

Drawing-No.: 42-119 053-02  
Date: 2003-05-12

## ALBANY DOOR SYSTEMS

### ASIA

KIARA PARK 172-3-2 • JLN. BURHANUDDIN HELMI  
TTDI, 60.000 KUALA LUMPUR  
PHONE: +60 (0) 3 77 27 01 84 • FAX: +60 (0) 3 77 27 01 84  
INFO.ADS.MY@ALBINT.COM

### AUSTRALIA

23 FAUNCE ST. WEST GOSFORD • 2250 NSW  
PHONE: +61 (0) 2 / 43 23 23 86 • FAX: +61 (0) 2 / 43 24 54 11  
SALES.ADS.AU@ALBINT.COM

### GERMANY

AM MONDSCHEN 25 • 59557 LIPPSTADT  
PHONE: +49 (0) 29 41 / 766-0 • FAX +49 (0) 2941 / 766-294  
VERKAUF.ADS.DE@ALBINT.COM

### SWEDEN

BOX 509 • S - 301 80 HALMSTAD  
PHONE: +46 (0) 35/14 73 00 FAX: +46 (0) 35/14 73 99  
SALES.ADS.SE@ALBINT.COM

### USA

975-A OLD NORCROSS ROAD • LAWRENCEVILLE • GA 30045-4321  
PHONE: +1 (0) 7 770 / 338 / 5000 • FAX: +1 (0) 770/338/5024  
SALES.ADS.US@ALBINT.COM

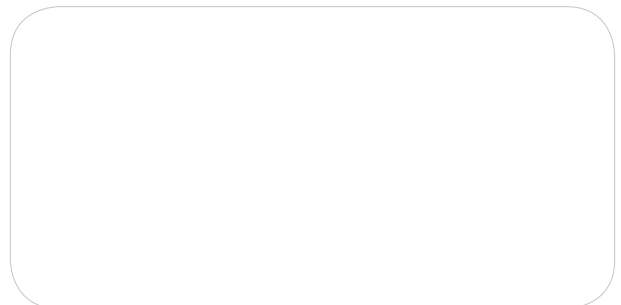

Albany Door Systems products and services are available around the world. For a subsidiary or a representative in your region visit

[WWW.ALBANYDOORS.COM](http://WWW.ALBANYDOORS.COM)